



Hours of Operation: Mon - Fri - 8:00 am – 5:00 pm
 Sat - 10:00 am – 2:00 pm
CLOSED: Sunday & Holidays
 Location: 5465 E. Nuggat St., Bldg. 4430
 Phone: (520) 228-3736/4491
 Website: www.dmforcesupport.com
 Facebook: www.facebook.com/DMODR
 (press F5 to refresh if the url is in your favorites)

Rental Equipment Price List
May 16, 2016

FOR THE RENTAL OF ALL EQUIPMENT

A Weekend Rate: Friday or Saturday pick-up to Monday drop-off.

A Holiday Rate Friday to Tuesday or Thursdays to Monday *IF we are closed on a Monday or Friday for a holiday.*

A Weekly Rate: 7 days, Friday to Thursday, Thursday to Wednesday, ect.

*Equipment marked with 2 asterisks (**) can be reserved. All other equipment is first-come first-served.*

<u>Camping Equipment</u>	Daily	Weekend	Holiday	Weekly
Backpack (camping, various sizes)	\$5.00	\$10.00	\$12.50	\$25.00
Bow Saw	\$2.00	\$4.00	\$5.00	\$10.00
Camp Chair (red, canvas)	\$4.00	\$8.00	\$10.00	\$20.00
Camp Table/Compact (small, square, wooden)	\$4.00	\$8.00	\$10.00	\$20.00
Coffee Pot – 12 Cup	\$2.00	\$4.00	\$5.00	\$10.00
Cook Set—6 Piece (aluminum set: 3 pots, 1 pan/lid, 1 lid, 1 detachable handle)	\$3.00	\$6.00	\$7.50	\$15.00
Cook Set—7 Piece (black bag, 2 pots, 1 pan, 2 lids, 1 detachable handle, 1 cutting board)	\$4.00	\$8.00	\$10.00	\$20.00
Cots (roll up or folding)	\$5.00	\$10.00	\$12.50	\$25.00
Dining Set – 12 Piece (4 plates, 4 bowls, 4 coffee mugs)	\$4.00	\$8.00	\$10.00	\$20.00
Dutch Oven	\$3.00	\$6.00	\$7.50	\$15.00
Hatchet	\$2.00	\$4.00	\$5.00	\$10.00
Heater – Tent (small, requires 1 small propane tank)	\$4.00	\$8.00	\$10.00	\$20.00
Heater – Tent (large, requires 2 small propane tanks)	\$5.00	\$10.00	\$12.50	\$25.00
Ice Chest – 40 quart	\$3.00	\$6.00	\$7.50	\$15.00
Ice Chest – 48 quart	\$3.50	\$7.00	\$8.75	\$17.50
Ice Chest – 68 quart	\$4.00	\$8.00	\$10.00	\$20.00
Ice Chest – 100 quart	\$5.00	\$10.00	\$12.50	\$25.00
Ice Chest – 150 quart	\$6.00	\$12.00	\$15.00	\$30.00
Lantern, Propane	\$4.00	\$8.00	\$10.00	\$20.00
Shovel (camp, small, folding)	\$2.00	\$4.00	\$5.00	\$10.00
Sleeping Bag – Adult (various kinds)	\$4.00	\$8.00	\$10.00	\$20.00
Self-inflating Camp Pad	\$4.00	\$8.00	\$10.00	\$20.00
Stove, 1-burner propane	\$3.00	\$6.00	\$7.50	\$15.00
Stove, 2-burner propane	\$4.00	\$8.00	\$10.00	\$20.00
Tarp	\$2.00	\$4.00	\$5.00	\$10.00
Tent 2-3 Person Dome	\$8.00	\$16.00	\$20.00	\$40.00
Tent 4-5 Person Dome	\$11.00	\$22.00	\$27.50	\$55.00
Tent 6-Person Instant Tent	\$13.00	\$26.00	\$32.50	\$65.00
Tent 8-Person Instant Tent	\$15.00	\$30.00	\$37.50	\$75.00

*Equipment marked with 2 asterisks (**) can be reserved. All other equipment is first-come first-served.*

Security Deposits can only be paid with Visa or Master Card & are refunded upon return.

A weekend rate is pick-up Fri. or Sat, return Mon. A holiday rate is Fri-Tues or Thurs-Mon, if we are closed for a holiday.

All equipment availability & prices are subject to change without notice. – May 16, 2016

Towable Camper Trailers

**** 2012 Scamp, 16 ft. Standard - fully-enclosed, hard shell travel trailer**

Features: sleeps one to four (2 adults, 2 small children), table converts to full bed, sofa converts to bunk beds (no more than 80 pounds on the top bunk), AC and heat, 2-burner stove, 12 gallon water tank, sink with pump, propane tank (**we do not fill the propane**), and 1.9 cubic ft. mini-fridge. **No toilet.**

Towing information:

Requires a class 2 hitch (no bumper hitches)
weighs 2000 pounds (unloaded), 16 ft.,
ball size 2 inches, 7 round electrical plug (no adaptors)
overall length 16', height 7' 10", width 6' 8"

Pricing:

Security Deposit: \$100.00
Daily: \$75.00
Weekend: \$150.00 (Fri. or Sat. pick-up to Mon. drop-off)
Holiday: \$187.50 (if we are closed for a holiday: Fri. to Tues. or Thurs. to Mon.)
Weekly: \$375.00 (7 days, Fri. to Thurs., Thurs. to Wed., ect.)



Scamp Floor Plan

1. Couch – converts to bunk beds
2. Storage
3. 2-burner stove, mini-fridge
4. Table, benches – converts to full bed
5. Sink, cabinet storage

**** 2014 "Nomad," 18 ft. Skyline Nomad - 163 Retro Expandable Travel Trailer** **OR ** 2015 Coachmen "Clipper" – 15RB Camping Trailer**

Features: sleeps up to seven, two pop-out queen beds on each end, table converts to full bed, sofa can be used as a bed, AC and heat, 2-burner stove, 17 gallon water tank, sink with pump, and 3 cubic ft. mini-fridge, **toilet**, shower, microwave, AM/FM/CD stereo with 4 speakers, 10 ft. electric awning, TV antenna with LR jack (no TV included), 2 propane tanks (**we do not fill the propane**)

Towing information: Requires a class 2 hitch (no bumper hitches),
weighs 2820 pounds (unloaded), 18 ft.,
ball size 2 5/16 inches, 7 round electrical plug (no adaptors)
overall length 18', height 9'1", width 7'

Pricing:

Security Deposit: \$250.00
Daily: \$100.00
Weekend: \$200.00 (Fri. or Sat. pick-up to Mon. drop-off)
Holiday: \$250.00 (if we are closed for a holiday: Fri. to Tues. or Thurs. to Mon.)
Weekly: \$500.00 (7 days, Fri. to Thurs., Thurs. to Wed., ect.)

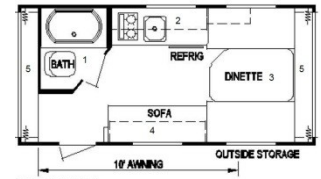
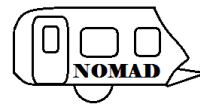

Model 163

Nomad & Clipper Floor Plan

1. Bathroom
2. 2-burner stove, mini-fridge
3. Table, benches – converts to full bed
4. Sofa

**** 2005 "A-liner," 13 ft. Chalet Alpine, Standard - pop up a-frame travel trailer**

Features: sleeps one to four, one dedicated full bed, table converts to full bed, 2-burner stove, AC and heat, 15 gallon water tank, sink with pump, propane tank (**we do not fill the propane**), and ice box. **No toilet.**

Towing information: Requires a class 2 hitch (no bumper hitches),
weighs 2000 lbs (unloaded), 13 ft.,
ball size 2", 7 round electrical plug (no adaptors)
overall length 13', height 5' (when traveling), width 7'5"

Pricing:

Security Deposit: \$100.00
Daily: \$65.00
Weekend: \$130.00 (Fri. or Sat. pick-up to Mon. drop-off)
Holiday: \$162.50 (if we are closed for a holiday: Fri. to Tues. or Thurs. to Mon.)
Weekly: \$325.00 (7 days, Fri. to Thurs., Thurs. to Wed., ect.)

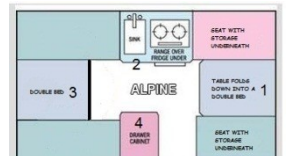

A-liner Floor Plan

1. Table, benches – converts to full bed
2. 2-burner stove, sink, ice box
3. Full bed

CAMPER Reservation Information

Security deposits are due at reservation on a **Visa or Master Card only**, and are refundable upon return. You can reserve up until 3 months in advance. **Campers require at least 48 hours advanced notice of reservation.** Camper pick up and return is by 3:00 PM Monday through Friday and 1:00 PM Saturday **Camper check out/in is extensive and can take 30 minutes to 1 hour to complete.**

*Equipment marked with 2 asterisks (**) can be reserved. All other equipment is first-come first-served.*

Security Deposits can only be paid with Visa or Master Card & are refunded upon return.

A weekend rate is pick-up Fri. or Sat, return Mon. A holiday rate is Fri-Tues or Thurs-Mon, if we are closed for a holiday.

All equipment availability & prices are subject to change without notice. – May 16, 2016

Watercraft & Fishing Equipment

**** Boat "Jon" - Flat Bottomed, 3-4 person**

Features: can seat 3-4, comes on a trailer with a 8 HP motor seat cushions, life jackets, oars, bailing bucket, anchor

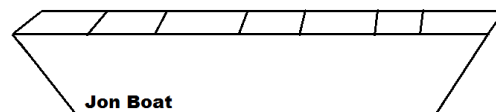

Towing information: 800 lbs, 14 ft, require a class 2 hitch (no bumper hitches) 1 7/8 inch ball and 4 flat electrical plug (no adaptors)

Pricing:

Security Deposit: \$100.00

Daily: \$40.00

Weekend: \$80.00 (Fri. or Sat. pick-up to Mon. drop-off)

Holiday: \$100.00 (if we are closed for a holiday: Fri. to Tues. or Thurs. to Mon.)

Weekly: \$200.00 (7 days, Fri. to Thurs., Thurs. to Wed., ect.)

**** Boat "Tracker" - V-Hull, 3-4 person**

Features: can seat 3-4, comes on a trailer with a 8 HP motor seat cushions, life jackets, oars, bailing bucket, anchor

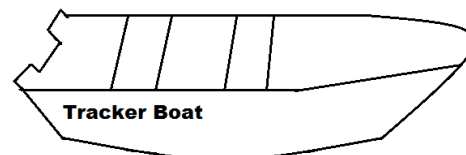

Towing information: 800 lbs, 14 ft, require a class 2 hitch (no bumper hitches) 1 7/8 inch ball and 4 flat electrical plug (no adaptors)

Pricing:

Security Deposit: \$100.00

Daily: \$45.00

Weekend: \$90.00 (Friday or Sat. pick-up to Mon. drop-off)

Holiday: \$112.50 (if we are closed for a holiday: Fri. to Tues. or Thurs. to Mon.)

Weekly: \$225.00 (7 days, Fri. to Thurs., Thurs. to Wed., ect.)

BOAT Reservation Information

Security deposits are due at reservation on a **Visa or Master Card only**, and are refundable upon return. You can reserve up to 3 months in advance.

Boats require at least 24 hours advanced notice of reservation.

Boat pick up and return is by 3:00 PM Monday through Friday and 1:00 PM Saturday

Boat check out and in is extensive and can take up to 30 minutes to complete.

Boaters Safety Course Certificate is required at reservation.

These can be acquired through FREE on-line tests through: <http://www.boatus.org/onlinecourse/Arizona.asp>

<u>Watercraft & Fishing Equipment</u>	Daily	Weekend	Holiday	Weekly
** Canoe (\$50.00 deposit)	\$15.00	\$30.00	\$37.50	\$75.00
** Canoe or Kayak Trailer	\$10.00	\$10.00	\$10.00	\$10.00
Fishing Pole	\$4.00	\$8.00	\$10.00	\$20.00
** Kayak – Traditional (\$50.00 deposit)	\$12.00	\$24.00	\$30.00	\$60.00
** Kayak - Ocean or Pedal (\$50.00 deposit) Ocean Kayak: sit-on-top & Pedal Kayak: foot-powered propellers	\$20.00	\$40.00	\$50.00	\$100.00
Life Jackets (various sizes)	\$4.00	\$8.00	\$10.00	\$20.00
** Paddle Boards (\$50.00 deposit)	\$15.00	\$30.00	\$37.50	\$75.00
Paddles/Oars	\$3.00	\$6.00	\$7.50	\$15.00
Seat Cushions	\$3.00	\$6.00	\$7.50	\$15.00
** Trolling Motor, Battery (\$50.00 deposit)	\$25.00	\$50.00	\$62.50	\$125.00

For the rental of our Watercraft

Boats, kayaks, and canoes require a **Boaters Safety Course Certificate** certified by the US Coast Guard.

These can be acquired FREE on-line tests through: <http://www.boatus.org/onlinecourse/Arizona.asp>

*Equipment marked with 2 asterisks (**) can be reserved. All other equipment is first-come first-served.*

Security Deposits can only be paid with Visa or Master Card & are refunded upon return.

A weekend rate is pick-up Fri. or Sat, return Mon. A holiday rate is Fri-Tues or Thurs-Mon, if we are closed for a holiday.

All equipment availability & prices are subject to change without notice. – May 16, 2016

<u>General Use Items</u>	Daily	Weekend	Holiday	Weekly
Appliance Dolly	\$5.00	\$10.00	\$12.50	\$25.00
Roll-Away Bed (twin)	\$12.00	\$24.00	\$30.00	\$60.00
Roll-Away Bed (double/full)	\$15.00	\$30.00	\$37.50	\$75.00
Santa Suit (\$35.00 deposit) – Hat, jacket, pants, boot covers, wig, bears	\$35.00	\$70.00	\$87.50	\$175.00
Elf Suit (\$15.00 deposit) – Hat, shirt	\$15.00	\$15.00	\$15.00	\$15.00
Yard Announcement Sign (“Happy Birthday” & “It’s a Boy/Girl”)	\$15.00	\$30.00	\$37.50	\$75.00

<u>Sports & Games Equipment</u>	Daily	Weekend	Holiday	Weekly
Badminton Set	\$4.00	\$8.00	\$10.00	\$20.00
Balls (various sports)	\$2.00	\$4.00	\$5.00	\$10.00
Baseball Bases	\$4.00	\$8.00	\$10.00	\$20.00
Batting Helmet	\$2.00	\$4.00	\$5.00	\$10.00
Bike – ElliptiGO (\$50.00 deposit, Elliptical/stand-up Bike) Hourly rates available: \$5.00 for 2 hours (minimum); \$3.00 each additional hour	\$25.00	\$50.00	\$62.50	\$125.00
Bike – Mountain (\$50.00 deposit) Hourly rates available: \$3.00 for 2 hours (minimum); \$2.00 each additional hour	\$15.00	\$30.00	\$37.50	\$75.00
Bike – Rack for Vehicle (\$25.00 deposit)	\$15.00	\$30.00	\$37.50	\$75.00
Bike – SPECIALIZED Road Bike (\$100.00 deposit) Hourly rates available: \$5.00 for 2 hours (minimum); \$3.00 each additional hour	\$25.00	\$50.00	\$62.50	\$125.00
Bike – Tandem (\$50.00 deposit, bicycle made for 2) Hourly rates available: \$4.00 for 2 hours (minimum); \$2.50 each additional hour	\$20.00	\$40.00	\$50.00	\$100.00
Bike – Trailer (\$50.00 deposit, tow-behind for children)	\$10.00	\$20.00	\$25.00	\$50.00
Bocce Ball (outdoor game, requires grass or sand – weighted ball toss)	\$5.00	\$10.00	\$12.50	\$25.00
Catcher Mask – Baseball	\$2.00	\$4.00	\$5.00	\$10.00
Corn Hole (outdoor game, bean-bag toss)	\$8.00	\$16.00	\$20.00	\$40.00
Disc Golf, 9-Hole & 4 Disc Sets (\$100.00 deposit, golf with frisbees)	\$25.00	\$50.00	\$62.50	\$125.00
Disc Golf – Disc Sets (4 discs)	\$4.00	\$8.00	\$10.00	\$20.00
Flag Football	\$5.00	\$10.00	\$12.50	\$25.00
Golf Clubs	\$10.00	\$20.00	\$25.00	\$50.00
Horseshoe Set	\$4.00	\$8.00	\$10.00	\$20.00
Ladder Ball (outdoor game)	\$5.00	\$10.00	\$12.50	\$25.00
Softball Bat	\$3.00	\$6.00	\$7.50	\$15.00
Softball Glove	\$4.00	\$8.00	\$10.00	\$20.00
Tennis Racquet	\$2.00	\$4.00	\$5.00	\$10.00
Trikke (3-wheeled mix between skis and a scooter) Hourly rates available: \$4.00 for 2 hours (minimum); \$2.50 each additional hour	\$12.00	\$24.00	\$30.00	\$60.00
Tug-of-War	\$4.00	\$8.00	\$10.00	\$20.00
Volleyball System (net, poles, ball)	\$17.00	\$34.00	\$42.50	\$85.00
Washer Game Set (outdoor game, washer toss)	\$5.00	\$10.00	\$12.50	\$25.00
** Picnic Kit (Softball Set, Tug-of-War Rope, Volleyball System, Horseshoes & Various Balls)	\$32.00	\$64.00	\$80.00	\$100.00

*Equipment marked with 2 asterisks (**) can be reserved. All other equipment is first-come first-served.*

Security Deposits can only be paid with Visa or Master Card & are refunded upon return.

A weekend rate is pick-up Fri. or Sat, return Mon. A holiday rate is Fri-Tues or Thurs-Mon, if we are closed for a holiday.

All equipment availability & prices are subject to change without notice. – May 16, 2016

<u>Lawn & Garden Equipment</u>	Daily	Weekend	Holiday	Weekly
Garden Hoe/Hula Hoe	\$3.00	\$6.00	\$7.50	\$15.00
Hand Shears (trimming)	\$3.00	\$6.00	\$7.50	\$15.00
Post Hole Digger (manual)	\$4.00	\$8.00	\$10.00	\$20.00
Pruning Shears (loppers)	\$3.00	\$6.00	\$7.50	\$15.00
Rake (garden/leaf)	\$3.00	\$6.00	\$7.50	\$15.00
Saw (hand)	\$3.00	\$6.00	\$7.50	\$15.00
Shovel (flat or round head)	\$3.00	\$6.00	\$7.50	\$15.00

<u>Group Event Items</u>	Daily	Weekend	Holiday	Weekly
** Barbeque Grill – “Small” (\$50.00 deposit, towable, fits about 50 hamburgers)	\$30.00	\$60.00	\$75.00	\$150.00
** Barbeque Grill – Rotisserie (\$50.00 deposit, towable, fits a pig)	\$35.00	\$70.00	\$87.50	\$175.00
** Barbeque Grill – Texas (\$50.00 deposit, towable, fits about 75 hamburgers)	\$40.00	\$80.00	\$100.00	\$200.00
** Barbeque Grill – 19’ x 5’4” Custom Smoker (\$100.00 deposit, towable, fits about 15 turkeys) Towing Requirements a Class 4 hitch, 2 5/16” ball, weighs 8000 lbs	\$60.00	\$120.00	\$150.00	\$300.00
** Barbeque Grill – Charcoal (\$50.00 deposit, towable, fits about 75 Hamburgers)	\$40.00	\$80.00	\$100.00	\$200.00
** Canopy – 10’ x 10’ (\$50.00 deposit, has 10 ft poles, not an “easy-up”)	\$35.00	\$70.00	\$87.50	\$175.00
** Canopy – 20’ x 20’ (\$50.00 deposit, has 20 ft poles, need a trailer, not an “easy-up”)	\$45.00	\$90.00	\$112.50	\$225.00
Cambro (hot or cold drink holder/dispenser)	\$5.00	\$10.00	\$12.50	\$25.00
** Chairs (black, folding, padded) reservations on chairs can only be for 25 or more chairs Bulk Rental Discounts: 25+ \$1.00 per chair, per day 50+ \$.75 per chair, per day	\$1.50 *Bulk* 25+ \$1.00 50+ \$.75	\$3.00 *Bulk* 25+ \$2.00 50+ \$1.50	\$3.75 *Bulk* 25+ \$2.50 50+ \$1.85	\$7.50 *Bulk* 25+ \$5.00 50+ \$3.75
Coffee Urn – 101 Cups	\$5.00	\$10.00	\$12.50	\$25.00
** Deep Fryer (\$50.00 deposit, great for turkey)	\$15.00	\$30.00	\$37.50	\$75.00
** Dunk Tank (\$50.00 deposit, 500 gallons)	\$40.00	\$80.00	\$100.00	\$200.00
** Horse/Water Trough	\$6.00	\$12.00	\$15.00	\$30.00
** Patio Heater (large propane tank)	\$15.00	\$30.00	\$37.50	\$75.00
** Tables (6’ x 2.5’ rectangle, white or black tables - seat 6-8) reservations on tables can only be for 10 or more tables Bulk Rental Discounts: 10+ \$2.00 per table, per day 20+ \$1.50 per table, per day	\$3.00 *Bulk* 10+ \$2.00 20+ \$1.50	\$6.00 *Bulk* 10+ \$4.00 20+ \$3.00	\$7.50 *Bulk* 10+ \$5.00 20+ \$3.75	\$15.00 *Bulk* 10+ \$10.00 20+ \$7.50
Water Jugs (for cold drinks, 5 gallons with dispenser)	\$4.00	\$8.00	\$10.00	\$20.00
** Water Wars (\$100.00 deposit, sling-shot water balloon game)	\$35.00	\$70.00	\$87.50	\$175.00

For the Rental of Grills & Dunk Tanks

Security deposits are due at reservation on a **Visa or Master Card only**, and are refundable upon return.

You can reserve up until 3 months in advance. **These items require at least 24 hours advanced notice of reservation.**

They weigh 100-500 lbs, are 8-10 ft, require a Class 2 hitch (no bumper hitches), 4 flat electrical plug (no adaptors) & 1 7/8 or 2 inch ball for towing. **We do not fill the propane tanks provided with the grills.**

EQUIPMENT RESERVATIONS & DEPOSITS

Equipment reservations are accepted on items marked with 2 asterisks () can be reserved. All other equipment is first-come first-served.**

• Reservations on tables can only be for 10 or more tables, reservations on chairs can only be for 25 or more chairs

A deposit must be charged to a VISA or MasterCard deposits are mandatory on the following items:

- \$250.00 deposit: “Nomad” camper
- \$100.00 deposit for each item: A-liners, Scamps, boat/motor/trailer, Water Wars & disc golf 9-hole set, and “Specialized” road bikes
- \$50.00 deposit for each item: mountain and tandem bikes, ElliptiGO, bike trailer, hand cycle, canoes, canopies, deep fryers, dunk tanks, grills, kayaks, paddle boards, and trolling motors
- \$25.00 deposit: bike rack for vehicle
- \$35.00 deposit: Santa suits
- \$15.00 deposit: Elf suits

*Equipment marked with 2 asterisks (**) can be reserved. All other equipment is first-come first-served.*

Security Deposits can only be paid with Visa or Master Card & are refunded upon return.

A weekend rate is pick-up Fri. or Sat, return Mon. A holiday rate is Fri-Tues or Thurs-Mon, if we are closed for a holiday.

All equipment availability & prices are subject to change without notice. – May 16, 2016

SKEET RANGE

Our Skeet & Trap Range is located at the end of Yuma Road

Hours of Operation

Saturday & Sunday 8:00 am - 12:00 pm (1 October to 30 March)
Saturday & Sunday 7:00 am - 11:00 am (1 April to 30 September)
Thursday 2:30 pm - 5:00 pm (1 October to T.B.D.)

Fees Per Round (25 shots):

\$4.50 (Military), \$5.50 (Guests/Non-military)
20 Round Shot Card—\$85.50 (Military), \$104.50 (Guests/Non-military)
50 Round Shot Card—\$211.50 (Military), \$258.50 (Guests/Non-military)

The Skeet & Trap Range is available for reservation

Reservations must be made in person at Outdoor Recreation.

Security Deposit: \$45.00 (due at reservation on a **Visa or Master Card only**, refundable)

- Reservations need to be made a minimum of 72 hours in advance
- A 1 week notice is preferred and will guarantee the reservation date/time.
- Reservations can be made for the hours of 8:00 am to 6:00 pm, Monday through Friday.
- There is no lighting on the field so shooting will end at sunset.
- Please take into consideration paydays and holidays, and have an alternative date/time if your first choice is not available.
- You must have your own ammunition, the Skeet & Trap Range does not have ammunition for sale.
- You and your guests can pay for your rounds while you are at the range (cash only).

Notice:

The Skeet & Trap Range does not have credit card capabilities and can only accept cash for rounds.
If you show your Air Force Club Card you can get a 10% discount (does not apply to reservation deposit).

PAINTBALL RANGE

Our Paintball Range is located on Yuma Road; it is available for reservation only.

Reservations must be made in person at Outdoor Recreation.

Security Deposit: \$50.00 (due at reservation on a **Visa or Master Card only**, refundable)

- Reservations need to be made at a minimum of 2 weeks in advance.
- You must have a minimum of 10 participants in your group to qualify for a reserved session.
- Sessions can be either a morning (8:00 to 11:00) or afternoon (1:00 to 4:00) any day of the week.
- Please take into consideration paydays and holidays, and have an alternative date/time if your first choice is not available.
- Ages 10-17 are authorized to participate & must be accompanied by & under the direct supervision of a parent or legal guardian, with a ratio of 1 adult to every 6 children.
- The cost for individuals needing a rental package is \$20.00 per person. This price includes the field fee, semi-auto marker, goggle/mask combo, 9 oz CO2 and 200 paintballs per player.
- The \$50.00 deposit does not go towards any rental packages.
- The cost for individuals who have their own gear is \$5.00 per person. This is the field fee only and does not include paintballs, rental equipment, or CO2.
- **Only paintballs purchased through Outdoor Recreation may be used on the field.**

Notice:

The Paintball Range does not have credit card capabilities and can only accept cash for refills.
If you show your Air Force Club Card you can get a 10% discount (does not apply to reservation deposit)

Extra equipment will be available to rent or purchase the day of your event.

CO2 Refills	Paintballs	Misc. Rental Fees
09 oz. \$3.00	100 Rounds \$3.00	Goggle/Mask \$2.00
12 oz. \$4.00	200 Rounds \$6.00	Chest Protector \$2.00

*Equipment marked with 2 asterisks (**) can be reserved. All other equipment is first-come first-served.*

Security Deposits can only be paid with Visa or Master Card & are refunded upon return.

A weekend rate is pick-up Fri. or Sat, return Mon. A holiday rate is Fri-Tues or Thurs-Mon, if we are closed for a holiday.

All equipment availability & prices are subject to change without notice. – May 16, 2016

Reserve BAMA Park or Camp Lightning

- **BAMA Park** is great for picnics, parties, unit parties, and other base functions and there is water and bathrooms available.
- **Camp Lightning** is great if you want to do a bit of camping on base and there is water and a concrete pad available.

Cleaning Deposit: \$50.00 (paid by Visa or Master Card only)

Cleaning deposit is required at the time of reservation. The deposit holds the reservation and will be returned after the Outdoor Recreation Staff is assured the park has been cleaned after the function. It is recommended that reservations be made a minimum of two weeks in advance. **BAMA Park now has table tennis!**

You can **rent 2 paddles & 1 ball** for: \$1.00 **hourly** \$8.00 **daily** \$16.00 **weekend** \$20.00 **holiday weekend** \$40.00 **weekly**

Heritage Park

Heritage Park is the large concrete parade ground located at the corner of Craycroft Rd & Quijota Blvd. There are no pavilions or picnic tables. Heritage Park must be reserved through Outdoor Recreation. There is no fee associated with this reservation.

Outdoor Recreational Skate Park

The Skate Park is open from dawn to dusk for all authorized users. Skaters must stop by Outdoor Recreation and fill out a waiver/release of liability and receive a sticker for their helmet. Anyone under 18 years of age must have their parent or legal guardian sign the waiver/release of liability. Safety gear must be worn at all times while using the park.

Outdoor Recreation Adventure Programs & Trips

Outdoor Recreation offers a variety of programs and trips throughout the year, white water rafting, hiking, family camping, horseback riding, tandem skydiving, AZ Diamondbacks baseball, Cardinals football, Disneyland and Price-Is-Right. Look for our quarterly brochures and flyers. **For FIRST NOTICE of trips like us on Facebook @ www.facebook.com/DMODR**
Volunteer opportunities are available, please contact Outdoor Recreation at 228-3736 for more information.

INDOOR FITNESS POOL

Inside Benko Fitness Center
 Bldg 2301 on 5th Street, 228-0015
 Mon - Fri.....6:00 am - 6:00 pm
 Sat - Sun.....CLOSED
 Holidays.....CLOSED

OUTDOOR RECREATIONAL POOL

6090 Quijota Blvd., 228-3759

26 May 2016 to 5 September 2016

Daily Fees: \$2.00 ADULT, \$1.00 CHILD

FAM CAMP

For Military:

Full Hook-Up - \$20 per night
 Overflow - \$9.00 per night
 3 Month Contract - \$1,890
 6 Month Contract - \$3,843

For Guests/Non-military:

Full Hook-Up - \$25 per night
 Overflow - \$15 per night
 (non-ID card holders cannot
 get a 3 or 6 month contract)

Location: 6170 Quijota Blvd, Bldg. 6015

Phone: 520-747-9144

RV Storage Lot

Located on Yuma Rd next to the Paintball Range
 RV Storage is priced per month

10'x20'..... \$32.00
 12'x25'..... \$38.00
 15'x40'..... \$45.00
 15'x50'..... \$50.00

After the 10th of the month there will be a \$10.00 late fee.
 Vehicles must be running with current registration and insurance.

Outdoor Recreation has FEDEX EXPRESS

We offer 3-Day Express and Overnight Express. FedEx picks up from our location Monday-Friday, for guaranteed overnight you will need to have your **boxes in to us by 2:00 PM each day**. FedEx will pick up any size boxes up to 150 pounds.

Saturday Delivery is available dependent on zip code.

International shipping is available and requires box dimensions, weight, and customs claim amount.

FedEx cannot deliver to PO or APO boxes. Sorry, FedEx will not pick up GROUND from our facility.

<u>Other Outdoor Recreation Centers</u>	<u>Phone</u>	<u>Website</u>
Luke AFB, Arizona	Com: 623-856-6267/9334	www.lukeevents.com
Fort Tuthill, Arizona	Com: 928-774-8893	www.forttuthill.com
Fort Huachuca, Arizona	Com: 520-533-6707/6708	www.mwrhuachuca.com
Yuma, Arizona	Com: 928-328-3989/2400	www.yumamwr.com
Gila Bend, Arizona	Com: 623-856-5290	-
Camp Pendleton, California	Com: 760-725-5296/7519	www.mccscp.com/recreation-checkout
Miramar, California	Com: 858-577-4150	www.mccsmiramar.com/oac.html

*Equipment marked with 2 asterisks (**) can be reserved. All other equipment is first-come first-served.*

Security Deposits can only be paid with Visa or Master Card & are refunded upon return.

A weekend rate is pick-up Fri. or Sat, return Mon. A holiday rate is Fri-Tues or Thurs-Mon, if we are closed for a holiday.

All equipment availability & prices are subject to change without notice. – May 16, 2016